

CONNECTOR MANUFACTURERS

TOPTEK®
HARDWARE ELECTRONIC MANUFACTURER

www.toptek-co.com

Pin Header 3.96mm 1 Row H=3.2mm Stack SMT Type

Specifications
 Current Rate: 7 AMP
 Insulation Resistance: 1000MΩ Min.
 Contact Resistance: 20mΩ Max.
 Dielectric Voltage: 1000V AC for one minute
 Operation Temperature: -40°C to +105°C

Material
 Insulator: Polyester, UL 94V-0
 ©Standard: LCP
 Terminal: Copper Alloy
 Plating: Tin Plated

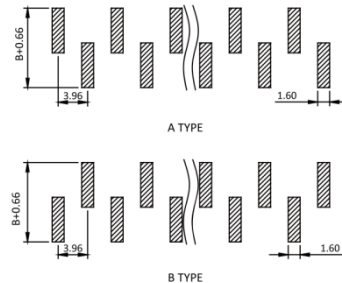
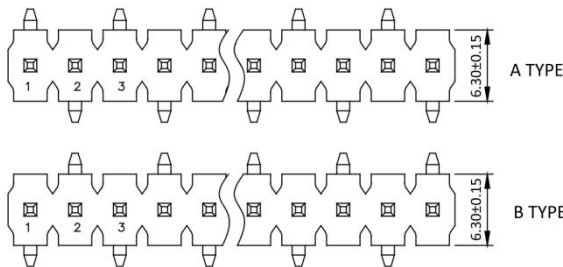

Recommended P.C.B Layout (Top Side)
(PCB BOARD TOLERANCE ±0.05)

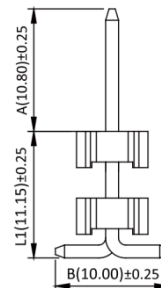
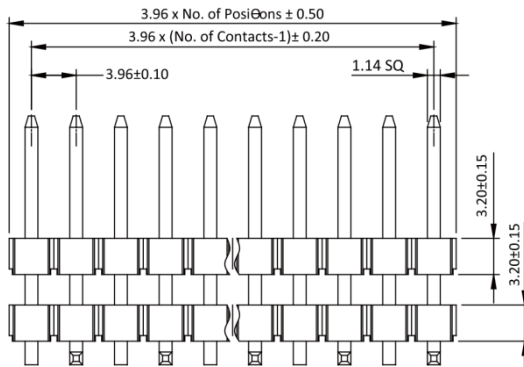

ORDER INFORMATION

Part No.: PH396DM32-1XX-X

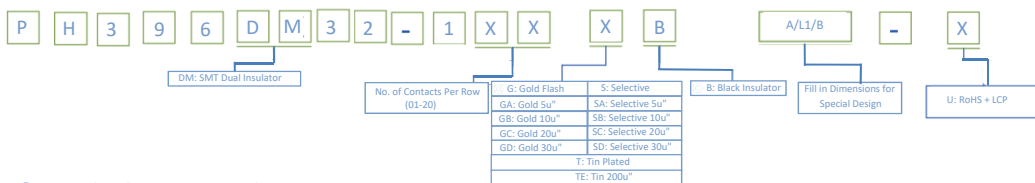

©: Standard Recommend

www.toptek-co.com

info@toptek-co.com

